

# INSTALLATION AND SERVICE MANUAL

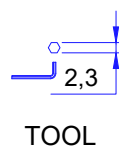

For Installation of COB Module Assembly on Odessa 2 Floodlight  
Model. UOD-2XXXX

## Product drawing (dimensions) SUITABLE FOR WET LOCATIONS

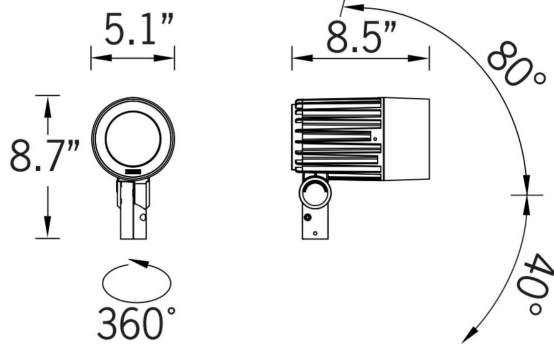

TOOL

Remove 3 Screws Located behind Bezel  
\*See Blue arrows - Separate Bezel From  
Fixture housing\*

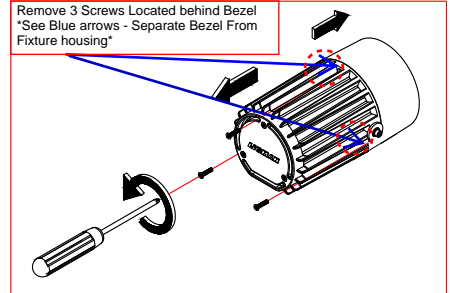

Twist off Reflector  
(Counter Clockwise)

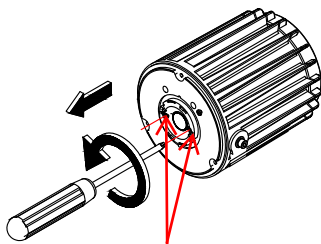
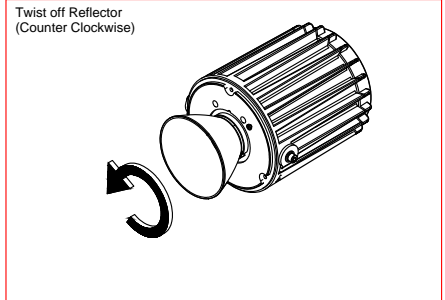

Remove (2) Screws on COB Holder

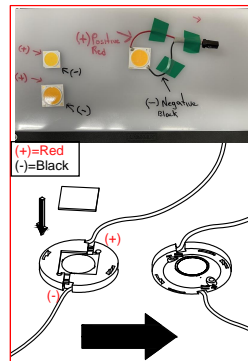
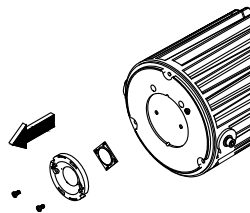

Install COB and COB Lamp Holder  
onto Fixture Housing  
Threads are Fragile - Tighten with Care

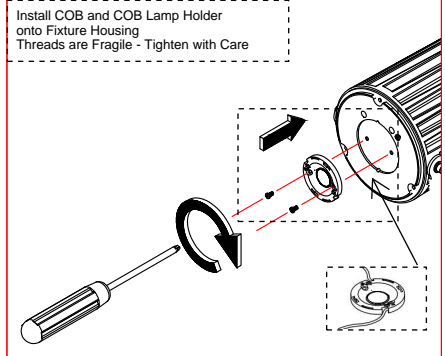

Twist on Reflector  
(Clockwise)

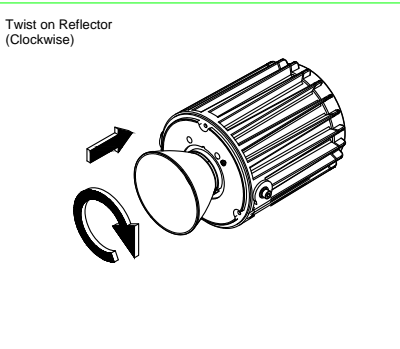

Reinstall Screws that Secure  
Bezel to Fixture Housing  
3 Screws

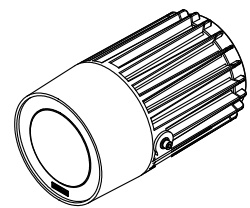
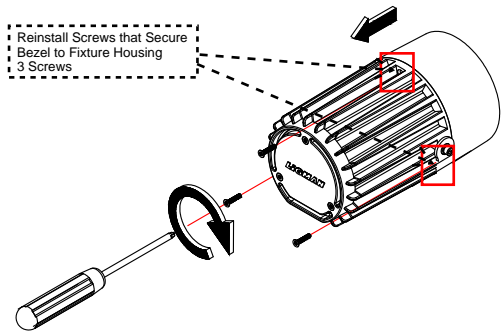

### Notice to installer :

**1.WIRING INSTRUCTIONS** Warning : RISK OF FIRE AND ELECTRICAL SHOCK. : FIXTURE MUST BE INSTALLED BY A QUALIFIED ELECTRICIAN ONLY>FIXTURE IS INTENDED FOR INSTALLATION IN ACCORDANCE WITH THE NATIONAL ELECTRICAL CODE, LOCAL AND FEDERAL CODE SPECIFICATIONS. DISCONNECT POWER BEFORE SERVICING.

Ligman Lighting USA

7144 NE Progress Court, Hillsboro  
Oregon, 97124, USA  
Tel : 503 645 0500 | Fax : 503 645 8100

[www.ligmanlightingusa.com](http://www.ligmanlightingusa.com)

2/25/2025-DZ-REV